

NICHOLS™  
& STONE  
SINCE 1857



OCTOBER 2014 MARKET INTRODUCTIONS

## DINING



**NS-2961  
(64 inch)**

### HANCOCK DINING TABLE

One piece top with breadboard ends. Tapered legs, with shaped front edge. Aprons feature shaped bottom edge. Available in solid maple with a solid birch top.

**NS-2961 (64 inch)**

H30 W34¼ L64

Distance (Apron to floor 25¾)

**NS-2960 (80 inch)**

H30 W40 L80

Distance (Apron to floor 25¾)

(Cover Image: **NS-2962** Wellfleet 42" Round Pedestal Table,

**NS-653-A-L** Wellfleet Upholstered Back Arm Chair, **NS-653-S-L** Wellfleet Upholstered Back Side Chair)

## DINING



### HANCOCK BUFFET & CHINA TOP

Buffet has three lipped drawers with wood knobs and frame and panel doors with raised panels and wood knobs. Two adjustable shelves. China top features three-lipped doors with wood knobs and interior lights w/dimmer. Adjustable glass shelves with plated grooves.

Open area below doors has ship lap back, with light strip and dimmer.

Available in maple solids with a solid birch top. 2-tone option available.

**NS-2967 (Buffet)**

H35 W73¼ D20

**NS-2968 (China Top)**

H49¾ W76 D17

## DINING



### WELLFLEET 42" ROUND PEDESTAL TABLE

Split top with one 12" **self-storing butterfly folding leaf**, pedestal base, and aprons.  
Extends to 54". Available in maple solids with a solid birch top.

**NS-2962**

H30 Dia.42

Distance (Apron to floor 25¾)



### WELLFLEET UPHOLSTERED BACK ARM & SIDE CHAIR

Mid century modern styling. Available in solid birch.

**NS-653-A-U**  
(Arm Chair in Fabric)  
H33½ W22 D26  
Arm Height 25½

**NS-653-A-L**  
(Arm Chair in Leather)  
H33½ W22 D26  
Arm Height 25½

**NS-653-S-U**  
(Side Chair in Fabric)  
H33½ W19¾ D26

**NS-653-S-L**  
(Side Chair in Leather)  
H33½ W19¾ D26

DINING



HANCOCK SIDEBOARD

Six drawers with molded, lipped edges and wood knobs. Bottom shelf.  
Available in maple solids with a solid birch top.

**NS-2965**  
H38 W56 D18

## DEPARTURES



### CARLISLE HALL/TV CONSOLE

Two drawers. Glass doors, and adjustable shelf behind left and center doors, plus one behind right door. Electrical strip behind doors. Available in maple solids.

**NS-50751-110**

H35¼ W65½ D16

**NS-50751-833**

H35¼ W65½ D16

DEPARTURES



AMERICAN RUSTIC TV/HALL CONSOLE

Two drawers over three doors and adjustable shelf behind left and center doors, plus one behind right door. Electrical strip behind doors. Available in solid cherry.

**NS-56000-321**

H35½ W66½ D16

# NICHOLS & STONE OCTOBER 2014 NEW PRODUCT INTRODUCTIONS

## DEPARTURES

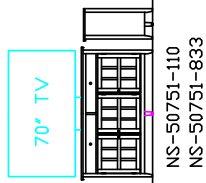

NS-50751-110  
NS-50751-833

## AMERICAN RUSTIC COLLECTION

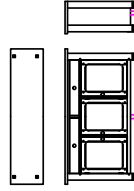

NS-56000-321

## WELLFLEET COLLECTION

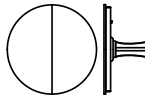

NS-2962

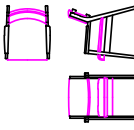

NS-653-A-L  
NS-653-A-U

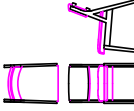

NS-653-S-L  
NS-653-S-U

## HANCOCK DINING ROOM

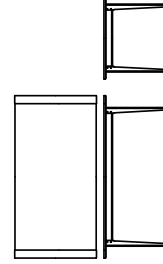

NS-2960

REVISED FROM 78 TO 80

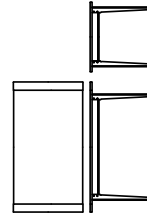

NS-2961

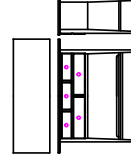

NS-2965



NS-2968 CHINA DECK  
NS-2967 BUFFET

**NICHOLS & STONE**  
SINCE 1857

P.O. BOX 480 • MANLIUS, NY 13104-0480 • T (315) 682-1554 • F (315) 682-2431  
NICHOLSANDSTONE.COM